



MBAV REG No. M1492



REGISTERED  
Building Practitioner

REG No. DB-U28406



REG No. 849681

# Modern Contemporary Woolamai 1

ON DISPLAY

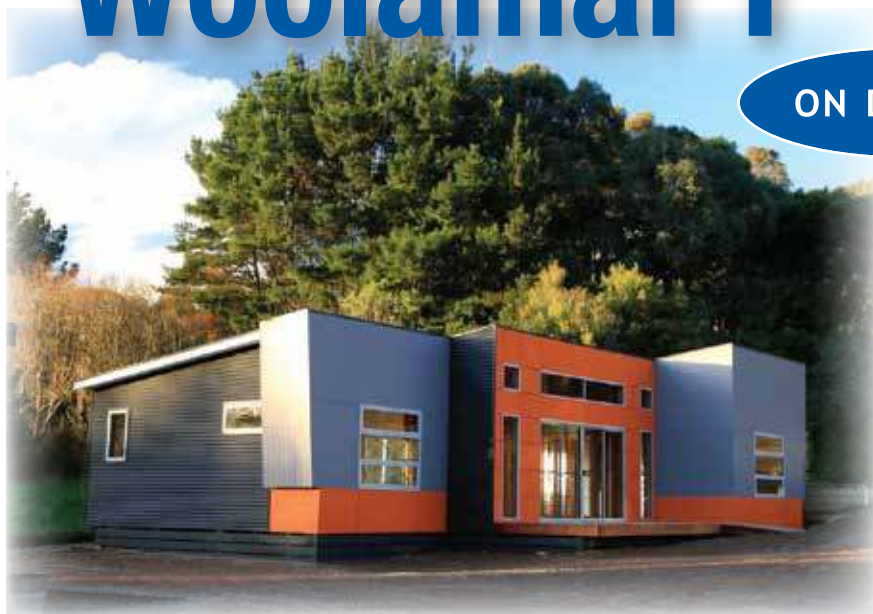

14455

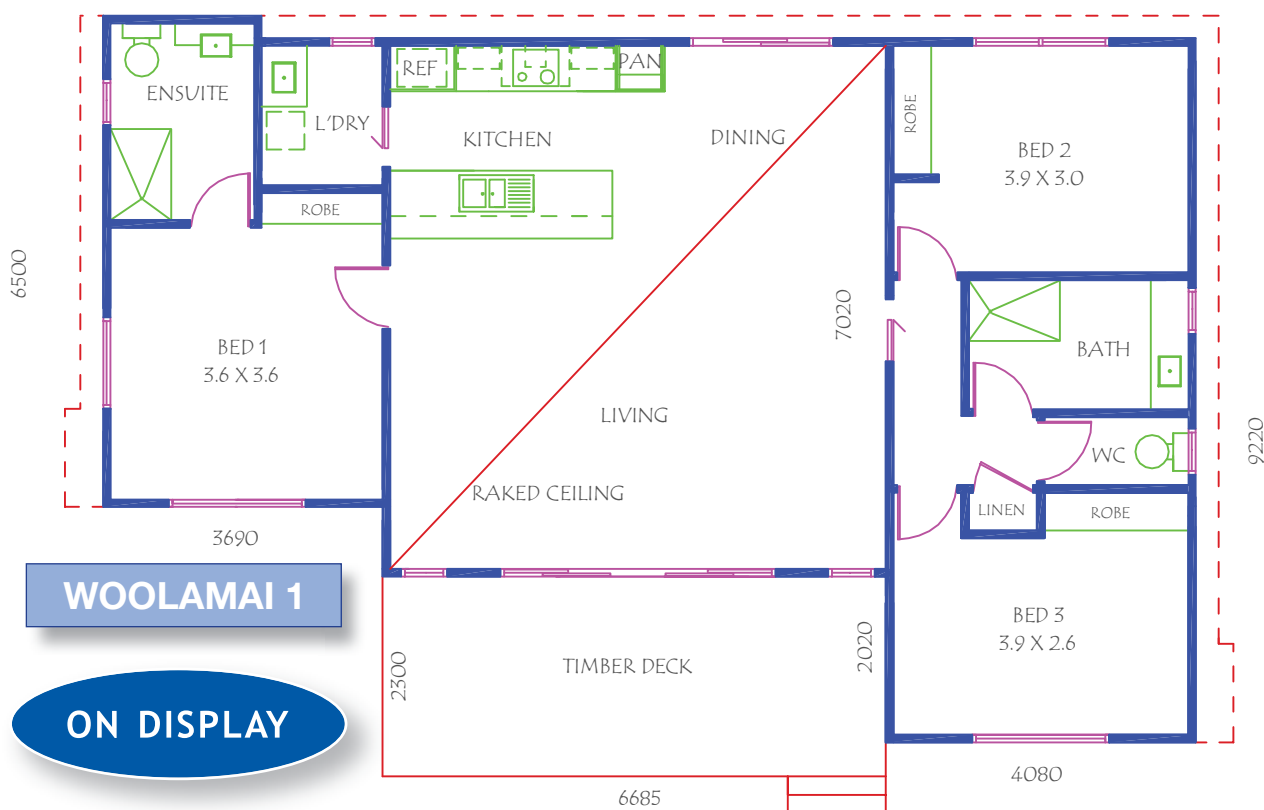

**WOOLAMAI 1**

ON DISPLAY

## Floor Area

109.04 m2 / 11.74 Sqs

### Plus Deck

15.38 m2 / 1.66 Sqs

Total: 124.48 m2 / 13.39 Sqs

## Roof

Colorbond®: 7.5°

## Exterior Cladding

Combination of: James Hardie™ Scyon™ Axon™ Shadowclad, Scyon™ Matrix™ Cladding with Colorbond® Corrugated Iron.

Aluminium sliding doors & awning windows are all double glazed (excluding bathroom/ensuite/Wc/laundry)



\* Plans are to a scale of 100:1

VER010514

## **WOOLAMAI ON DISPLAY OPTIONAL UPGRADES**

### **KITCHEN UPGRADES**

- BENCH TOPS - LAMINEX® essastone™ BENCH TOPS 20MM	\$3,510
- DOORS AND PANELS - LAMINEX® WHITE GLOSS	\$ 480
- ISLAND BENCH REAR PANEL - LAMINEX® IMPRESSION™ NUANCE FINISH	\$ 150
- UNDER BENCH OVEN - TECHNIKA® 8 FUNCTION ELECTRIC	\$ 310
- COOKTOP - TECHNIKA® CERAMIC TOUCH PANEL ELECTRIC	\$ 670
- RANGEHOOD - TECHNIKA® 900MM STAINLESS STEEL CANOPY WITH EXTERNAL DUCTING	\$ 360
- DISHWASHER - TECHNIKA® 7 PROGRAM STAINLESS STEEL (STD AVAILABLE @ \$560)	\$1,130
- COST TO FIT DISHWASHER	\$ 480
- SINK - STAINLESS STEEL CLARK® 1.75 BOWL 1080MM	\$ 60
- TAPWARE - PHOENIX VIVID (ZETO) PIN LEVER MIXER	\$ 90
<b><u>TOTAL OPTIONAL KITCHEN UPGRADE PACKAGE</u></b>	<b><u>\$7,240</u></b>

### **LAUNDRY**

- TAPWARE - PHOENIX VIVID (ZETO) PIN LEVER MIXER TO INSERT TROUGH	\$ 90
---	-------

### **BATHROOM**

- TAPWARE – PHOENIX MIA TWIN SHOWER	\$ 195
- MIXER TAP – PHOENIX VIVID (ZETO) PIN LEVER MIXER	\$ 95

### **LIGHTING**

- KITCHEN – ALMERA PENDANT LIGHTS OVER ISLAND BENCH 3 @ \$180 EACH	\$ 540
- BEDROOM 1 – ALMERA WALL LIGHTS 2 @ \$165 EACH	\$ 330

### **FANS**

- LIVING ROOM – CEILING SWEEP FAN INCLUDING ROD (OR FIT OWNERS @ \$180 EACH)	\$ 350
- BATHROOM AND ENSUITE – 2 LAMP FAN, HEATER AND LIGHT 2 @ \$220 EACH	\$ 440

### **FLOOR COVERINGS**

- VIC ASH TONGUE & GROOVE POLISHED FLOORBOARDS 85.00M <sup>2</sup> @ \$186M <sup>2</sup>	\$15,800
--	----------

### **INCLUSIONS AT NO EXTRA COST**

**KITCHEN** – OVERHEAD CUPBOARD WITH - TECHNIKA® BELLISSIMO™ 900MM STAINLESS STEEL SLIDE OUT RANGEHOOD VENTED EXTERNALLY FEATURING OPEN SHELVED CUPBOARDS TO EITHER SIDE

- WINE RACK TO END OF ISLAND BENCH
- TWO SETS OF POT DRAWERS.

**BATHROOM** - SHOWER – 1200MMX900MM TILED SHOWER BASE INCLUDING CLEAR GLAZED SEMI-FRAMELESS SHOWER SCREEN

- VANITY UNIT – FLOATING CUSTOM BUILT INCLUDING PIGEON HOLED TOWEL RACK AND TILED SKIRTING

- BASIN CAROMA® CARBONI II COUNTER TOP SQUARE VITREOUS CHINA BASIN AND MIXER TAP

**ENSUITE** – SHOWER - 1220MM X 900MM ACRYLIC SHOWER BASE AND CLEAR GLAZED SEMI-FRAMELESS SHOWER SCREEN

- VANITY UNIT – CUSTOM BUILT WITH TILED SKIRT

- BASIN CAROMA® CARBONI II SEMI RECESSED SQUARE VITREOUS CHINA BASIN AND MIXER TAP

**WINDOWS & DOORS** – ALUMINIUM SLIDING DOORS & AWNING WINDOWS ARE ALL DOUBLE GLAZED (EXCLUDING BATHROOM/ENSUITE/W.C/LAUNDRY)

**LIVING ROOM** - PLASTER REVEALS TO WINDOWS AND DOORS ON FRONT FAÇADE

**LIGHTING** - EXTERNAL - 2 SCOUT WALL LIGHT FITTINGS TO FRONT FAÇADE

- INTERNAL - 12 WATT LED DOWNLIGHTS (WHITE) TO ALL AREAS