

LARGER HOMES FOR PERMANENT LIVING

DESIGNER RANGE

Warranwood 2

Larger Home featuring James Hardie™ 205mm James Hardie® HardiePlank™ rusticated weatherboard. 17° Colorbond® roof and Guttering plus 450mm eaves (unless shown) and aluminium windows in a range of colours.

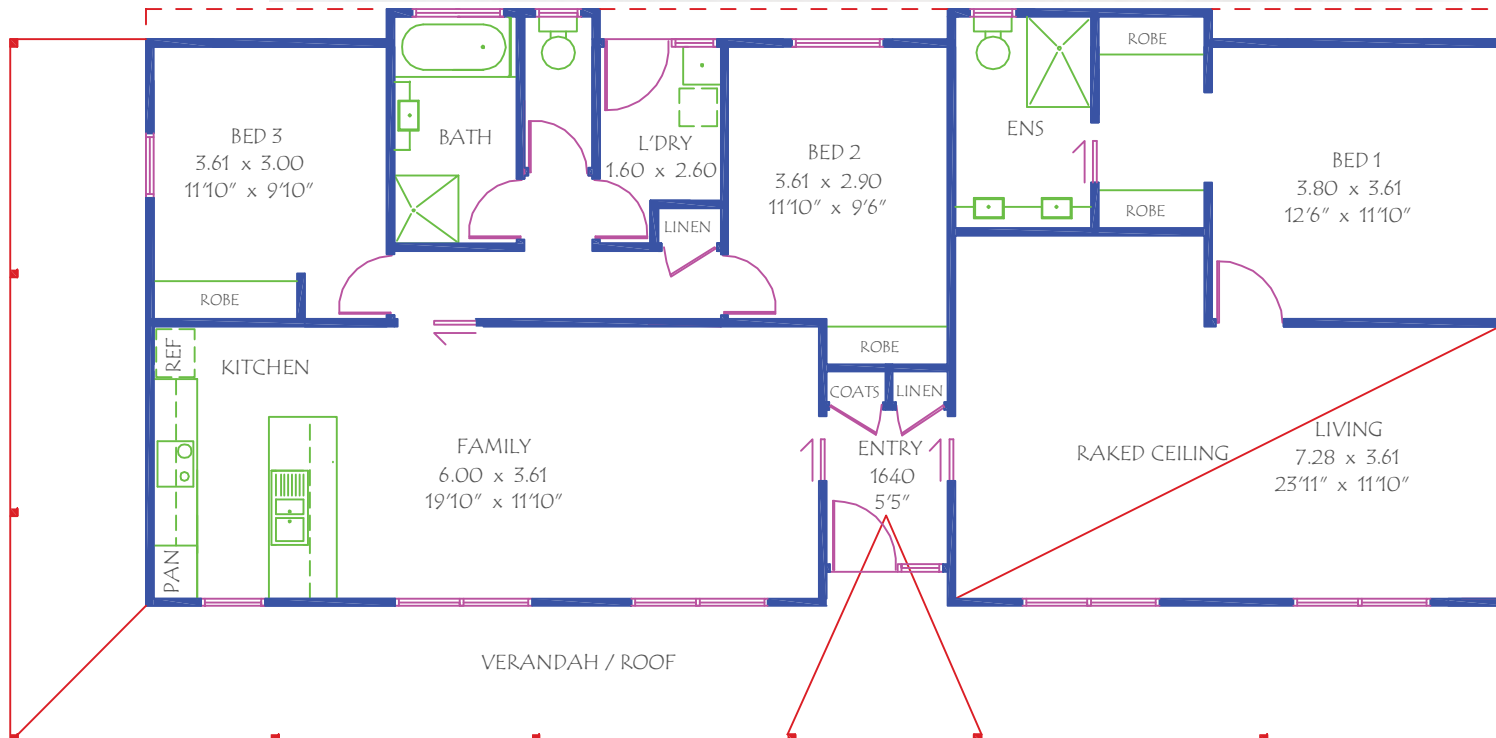

WARRANWOOD 2

Floor Area

137.83 m² / 14.84 Sqs

Verandah

49.14 m² / 5.29 Sqs

Total: 186.97 m² / 20.13 Sqs



ON DISPLAY

WARRANWOOD 2 ON DISPLAY OPTIONAL UPGRADES

DECK

- 70X22^{MM} TREATED PINE - 49.14M² @ \$176 M² OR \$ 8,650
- 90X19^{MM} MERBAU - 49.14M²@ \$226 M² \$ 11,105

BALUSTRADING

- STAINLESS STEEL WIRES WITH H3 TREATED PINE HAND RAIL 21.45^{LM} @ \$250^{LM} \$ 5,365

SUB FLOOR CLADDING

- CORRUGATED COLORBOND® WITH PERIMETER KORDON® TERMITE BARRIER \$ 4,200

60^{LM} @ \$70 (UP TO 300^{MM} OF FALL)

RAMP

- 3.9M² @ \$226 M² (MAX GRADIENT 1:10) \$ 885

AIR CONDITIONER

- SPLIT SYSTEM \$ 3,600

FLOOR COVERING

- GREY GUM TONGUE & GROOVE POLISHED TIMBER FLOOR \$ 6,540

LIGHTING

- CEILING SWEEP FANS 2 @ \$350 \$ 700
- ASSORTED LIGHT FITTINGS \$ P.O.A

INCLUSIONS AT NO EXTRA COST

- VERANDAH ROOF TO FRONT & END ELEVATION
- CEILING HEIGHT – 2,700^{MM} (9FT)
- ROOF PITCH - 20°
- HARDIES SCYON® LINEA WEATHERBOARDS WITH AXON® FEATURE PANELS
- PLASTER CORNICE – BORAL® SYDNEY 90^{MM}
- 2 LAMP FAN/HEATER/LIGHTS
- LINEN PRESS – ADDITIONAL FITTED TO PASSAGE
- ENSUITE – ONE ADDITIONAL VANITY BASIN - CAROMA® CARBONI 11 SEMI-RECESSED BASIN WITH MIXER TAP
- RECESSED ALUMINIUM ENTRY FRAME & SIDELITE